

WORKSHOP
*Co-designing
Neighbourhoods
with Communities*



Alton ACTION



24 February 2021

Preliminary Proposals

Work in progress: amendments to the preliminary proposal

ACTIVITY 2 | Wednesday 18th of November

Alton ACTION SPACE

UCL

- New Residential
- New Lift Access
- Community Space
- Retail
- Supermarket
- Live-in Entrepreneurs' Studios
- Co-working Office Space
- Underground Parking



Golf Course / Richmond Park

Bus Turnaround relocated to Tunworth Crescent

- Increased bus standing capacity, allowing greater bus frequency and reliability
- Removal of buses standing within Downshire Field historic landscape
- Additional bus stops serving Alton West enhancing accessibility
- Removal of solid barrier on Danebury Avenue, replaced with bus gate (physical gate or camera monitored) allowing through route for buses and cycles only, allowing for bus route extension to Barnes Station
- Only two trees require removal

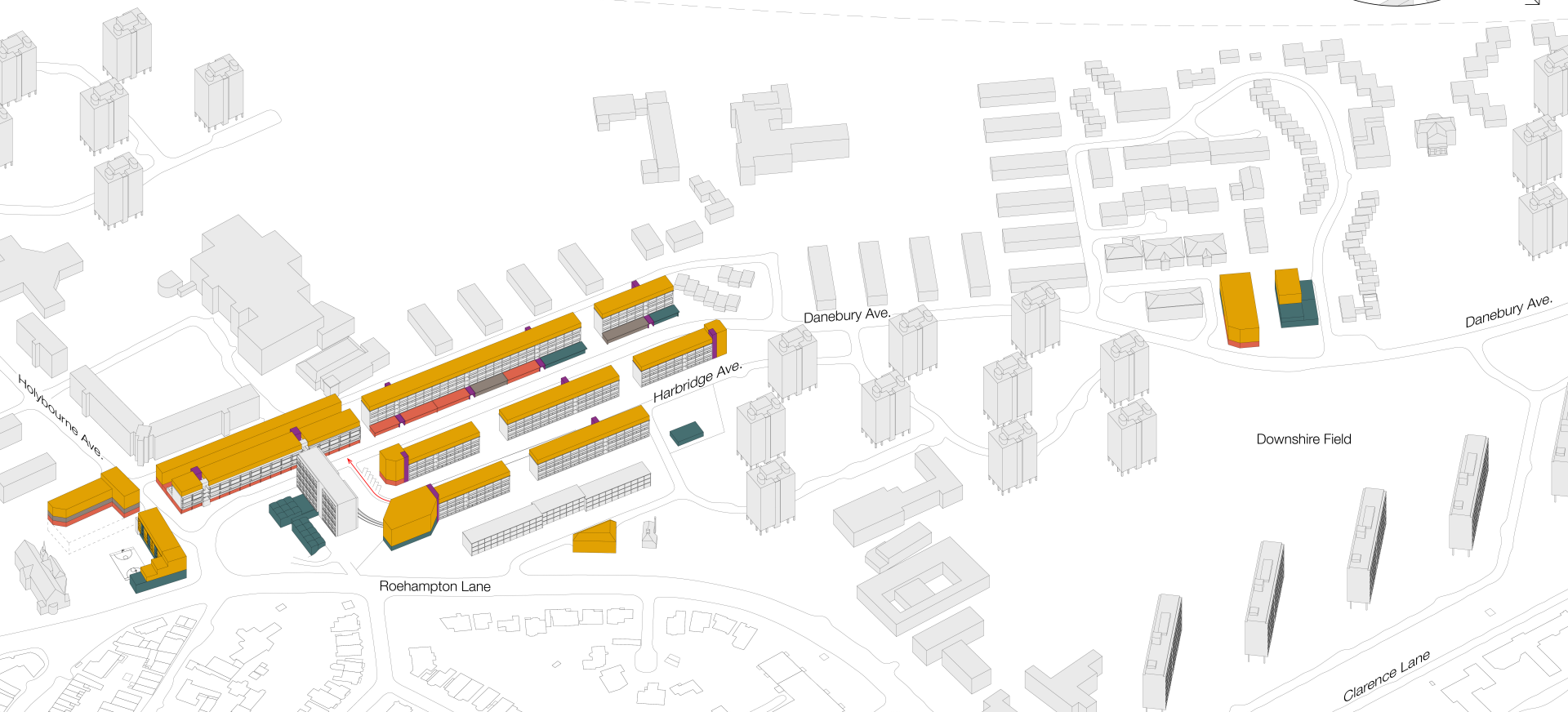
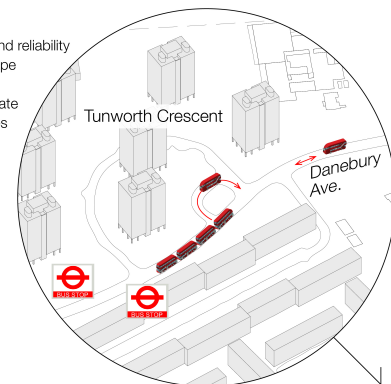

Site A

ACTIVITY 2 | Wednesday 24th of February

Alton ACTION SPACE

UCL



Albrook House

ACTIVITY 2 | Wednesday 18th of November

Alton ACTION SPACE

UCL

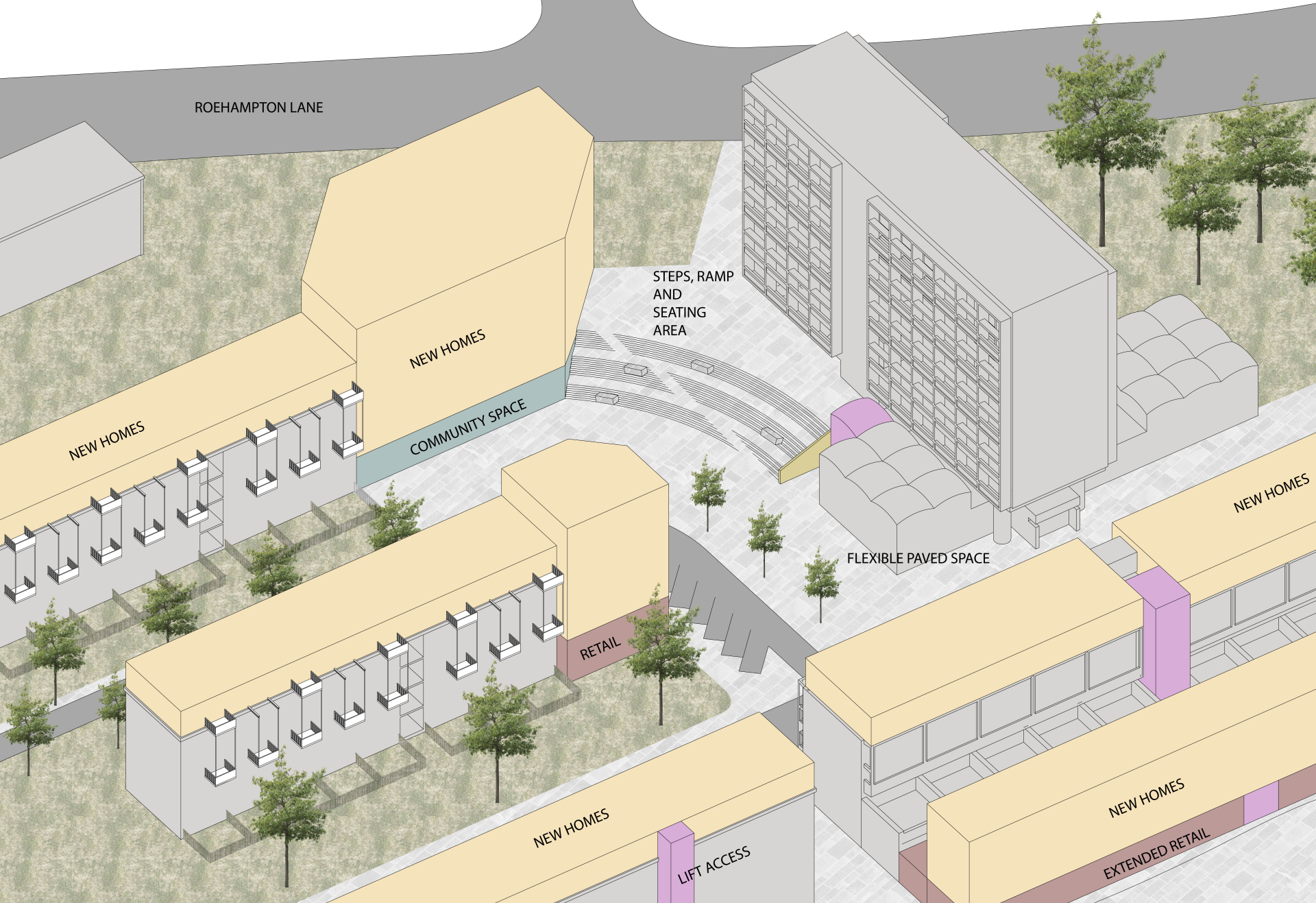

Portswood Place

ACTIVITY 2 | Wednesday 24th of February

Alton ACTION SPACE

UCL

